

# Phonic Ear™ Home Hearing Aid System

## Alerting Transmitters

### DETECT

A device that detects sound from the doorbell, telephone or other sound alerting device and transmits that sound wirelessly to the CALL, FLASH, WAKE, POCKETVIB, LOOP, BEAM, and LINK devices.



- The signal is transmitted wireless.
- Range is up to 75 metres.
- Long battery life.

NOTE: can be hard wired for door bell function.

### OBSERVER

The Observer has all the functions of the DETECT but can also function to alert the pager. When its built-in push button is activated, a signal is sent to an alerting receiver, paging the user.



- The signal is transmitted wireless.
- Range is up to 50 metres.
- Long battery life.
- Push button to work as a pager.

## Visual Alerting Receiver

### FLASH

A device that picks up a signal from the Detect and Observer (when connected, it alerts you to the sound of the telephone, doorbell, alarm or baby cry) and flashes a halogen lamp to alert you to the sound.

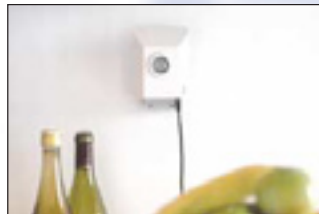

- Light device with built-in FM receiver.
- 7 different light signals.
- Powerful halogen bulb.
- Mountable on wall or table stand.

## Visual and Vibration Alerting Receivers

### POCKETVIB

A wireless body worn device which receives alarm signals from the Observer as well as the Detect and alerts the user by converting the sound to a vibration and a visual signal. Compact and light weight in design.



- Informs wearer through vibration and light display.
- Seven different vibration patterns, one for each sound source.
- Four differently-coloured lights to alert the user.
- Built in battery tester to indicate charge.
- Range is up to 50 metres.

### WAKE

A bedside alarm and alert device with under pillow vibrator to alert you to the alarm or other sounds from the Detect.



- Reacts only to frequencies above 600Hz → minimum risk of false alarms.
- Microphone detects sound from alarm clock and transforms it into vibrations.
- Optional battery backup recommended.
- Connects to 240v.

*NOTE: One Detect or Observer required for each sound ie: telephone, doorbell, alarm.*

Call **PRINTACALL** for Service

TM - Registered trademark of Phonic Ear Inc of USA.  
Phonic Ear / Logia Denmark

PRODUCT SPECIFICATIONS AND AVAILABILITY MAY CHANGE WITHOUT PRIOR NOTICE

# Phonic Ear™ Home Hearing Aid System

## Alerting Receivers via Sound

### LOOP

A teleloop amplifier and receiver device, which connects to the TV or radio, or to a microphone for conversation, sends clear sounds to your hearing aid with "T" switch or body-worn loop receiver. You can receive seven different alarm signals. Each alarm has its own unique sound pattern making it easier to distinguish between the different alarm signals such as the telephone, doorbell, alarm clock, security alarm. The Loop can be integrated with Detect and Observer devices.



- Adjustable volume.
- 2 inputs for radio and/or TV.
- 1 microphone input.
- Coverage up to 70m<sup>2</sup>.
- Wireless connection to Detect and Observer devices.

### BEAM

This consists of a transmitter and receiver. The transmitter is connected to the TV and stereo and the sound is transmitted via infra red signal to the receiver. The body worn receiver can be connected to a headphone, stetoclip or neckloop.



- Excellent solution if you do not have a "T" switch or hearing aid.
- First IR system to receive wireless alerting signals.
- Range of up to 12 metres.

### CALL

A device that picks up and transmits signals from the Detect or Observer and emits a pre-selected audio sound to alert you to a phone call, doorbell, alarm or baby cry.



- Small loudspeaker with built-in FM receiver.
- Adjustable volume, 0-95 dB SPL.
- Unlimited number of Call devices can be used.
- Mountable on wall or table stand.

### LINK

An auxiliary adaptor for use when listening to the TV and the stereo. FM users can receive important alarm signals while still enjoying the TV or stereo. The Link can be used with the Detect or the Observer (alerts you to the telephone, doorbell, alarm or baby cry).



- Ideal solution for those who use FM systems like Easy Listener, Solaris, or MicroLink.
- Wireless FM technology with the use of sound and alarms.

**INSTALLATION** *Ask Printacall to quote on installation in the Sydney Metro, ACT and Taree areas. Written instructions are provided with each product for do-it-yourself installation or you may choose a suitably qualified person in your area.*

TM - Registered trademark of Phonic Ear Inc of USA.  
Phonic Ear / Logia Denmark

Call **PRINTACALL** for Service

PRODUCT SPECIFICATIONS AND AVAILABILITY MAY CHANGE WITHOUT PRIOR NOTICE

**COMMUNICATIONS TECHNOLOGY FOR DEAF, HEARING IMPAIRED AND SPEECH IMPAIRED PEOPLE.**

# Phonic Ear™ Home Hearing Aid System

*You can be alerted to the...*

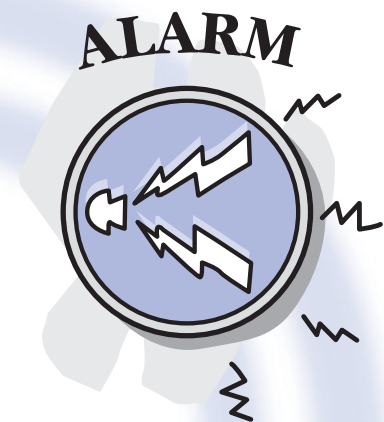

*Via a sound signal while...*

- EXAMPLE A** watching TV on the “**Loop**” via the T-switch.  
**EXAMPLE B** watching TV via the “**Beam**” (infra red headset).  
**EXAMPLE C** on the computer via a “**Call**” (small speaker unit).  
**EXAMPLE D** in the kitchen listening to the stereo with an FM receiver via the “**Link**”.

*Or via a visual signal...*

- EXAMPLE E** in the bathroom via the “**Flash**” (a flashing light).

*Or via a tactile and visual signal...*

- EXAMPLE F** in the garden via the “**Pocket Vib**” (a vibrating pager with 4 light displays).  
**EXAMPLE G** in bed via the “**Wake**” (a vibrating disk used with your existing alarm).

**You build on the system to suit your needs!**

Call **PRINTACALL** for Service

TM - Registered trademark of Phonic Ear Inc of USA.  
Phonic Ear / Logia Denmark

PRODUCT SPECIFICATIONS AND AVAILABILITY MAY CHANGE WITHOUT PRIOR NOTICE

**COMMUNICATIONS TECHNOLOGY FOR DEAF, HEARING IMPAIRED AND SPEECH IMPAIRED PEOPLE.**

An alerting transmitter (DETECT or OBSERVER) is placed near the sound source (such as the telephone). When an alarm is activated, (e.g., the telephone rings) the alerting transmitter transmits a signal to the receiver (CALL, FLASH, POCKETVIB, WAKE, LOOP, BEAM, or LINK) in the form of a sound, a flashing light, or a vibration to alert the person.

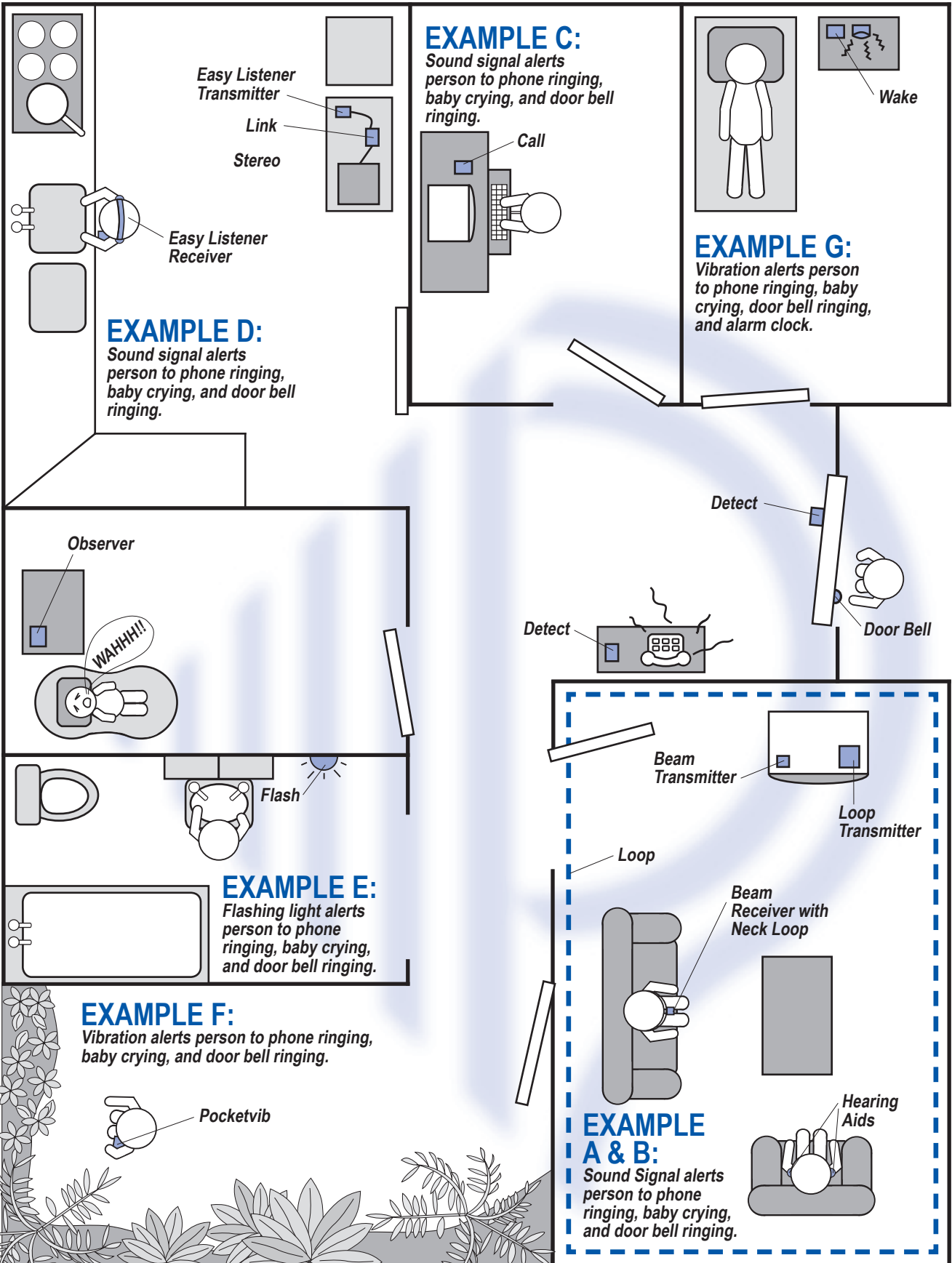

Call **PRINTACALL** for Service

PRODUCT SPECIFICATIONS AND AVAILABILITY MAY CHANGE WITHOUT PRIOR NOTICE

COMMUNICATIONS TECHNOLOGY FOR DEAF, HEARING IMPAIRED AND SPEECH IMPAIRED PEOPLE.